



Platform Lifts

Aritco 7000

Aritco 9000



Aritco 7000 & 9000 Prime Collection

Two lifts designed to meet the quality, safety and service requirements for accessibility and movement in tough environments such as schools and commercial and residential buildings. The 9000 lift is complete with an internal cabin and automatic run.

Advantages offered:

- Design, sizes and options for public environments
- 'A' Rated energy consumption
- 95% Recyclable materials
- Patented screw/nut technology (no oil leaks)
- The lowest maintenance and operating costs on the market
- Hold to run from control panel: 7000
- Automatic 'one touch' cabin control 9000



HUSBANDS

LIFT SOLUTIONS Est.1963

L.A. Husbands Ltd. Shelah Road, Halesowen, West Midlands B63 3PP

Tel: 0121 550 1560 Fax: 0121 585 5285 e-mail: enquiries@husbands.co.uk www.husbands.co.uk

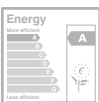

Platform Lifts

Aritco 7000

LIFT COLOUR

Can be painted in any RAL colour from the RAL Classic chart.

GLASS

4 different glass types to choose from.



FLOOR

9 different floorings to choose from.

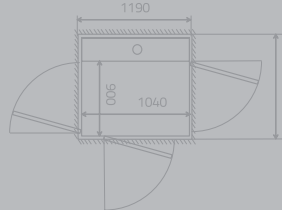

Size: 900 x 1040mm
Rated load: 250 kg/2 pers.
Wheelchair: –

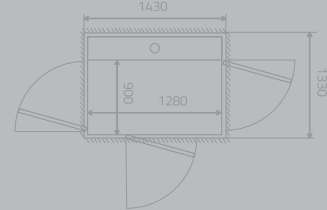

Size: 900 x 1280mm
Rated load: 410kg/5 pers.
Wheelchair: Lone user or type A*

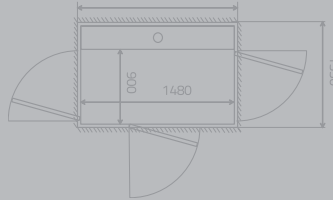

Size: 900 x 1480mm
Rated load: 410,500kg/5-6 pers.
Wheelchair: A or B with attendant*

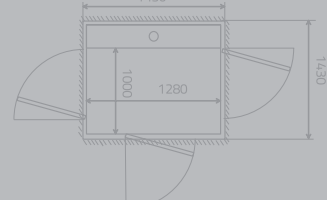

Size: 1000 x 1280mm
Rated load: 410kg/5 pers.
Wheelchair: Lone user or type A*

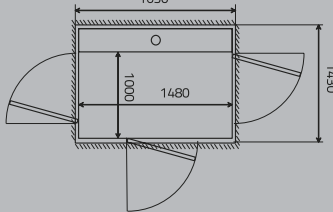

Size: 1000 x 1480mm
Rated load: 410,500kg/5-6 pers.
Wheelchair: A or B with attendant*

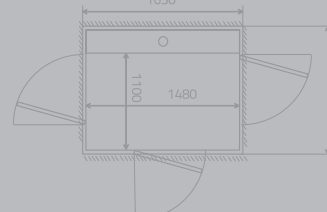

Size: 1100 x 1480mm
Rated load: 410,500kg/5-6 pers.
Wheelchair: A or B with attendant, adjacent entry*

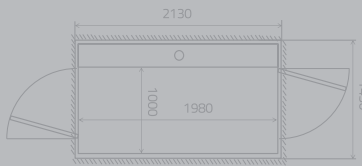

Size: 1000 x 1980mm
Rated load: 500kg/6 pers.
Wheelchair: A or B with attendant*



Size: 1100 x 1580mm
Rated load: 500kg/6 pers.
Wheelchair: A or B with attendant, adjacent entry*

Aritco 9000

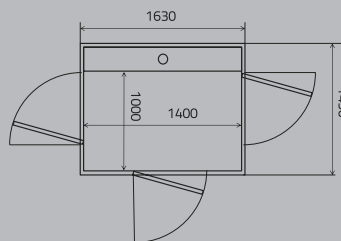

Size: 1000 x 1400mm
Rated load: 400kg/5 pers.
Wheelchair: A or B with attendant*

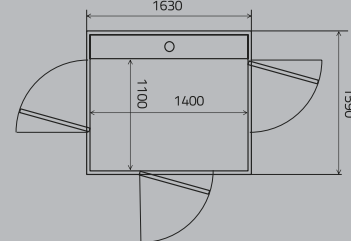

Size: 1100 x 1400mm
Rated load: 400kg/5 pers.
Wheelchair: A or B with attendant, adjacent entry*

* National guidelines may apply. Wheelchair Type A and B according to EN 12183/EN 12184.

Product summary

MODEL	TYPE OF LIFT	INSTALLATION		POWER SUPPLY V		DRIVE SYSTEM Patented screw & nut system	MAXIMUM RATED SPEED m/s	MINIMUM TOP HEIGHT mm	TRAVEL HEIGHT mm	NUMBER OF FLOORS	CONTROL FROM CARRIER CONTROL PANEL	EMERGENCY LOWERING	TECHNICAL COMPLIANCE
Aritco 7000	Platform Lift intended for installation in public environments	Recessed 50mm below floor	Direct on floor with 50mm ramp	230V 1-phase	400V 3-phase	2.2kW motor	0.15	2,240	250-13,000	2-6	Hold to run – press & hold	Battery powered	European Machine Directive 2006/42/EC European standard 81-141
Aritco 9000		Recessed 75mm below floor	Direct on floor with ramp	400V 3-phase		3kW motor		2,400	2,150 ¹ -13,000	2-6	Press one time to operate lift		European Machine Directive 2006/42/EC

¹ For opposite entry, 2,300mm when doors on same side.